



Piccadilly Close

Roselands, Northampton

oriordanbond
SALES & LETTINGS



GROUND FLOOR
319 sq.ft. (29.6 sq.m.) approx.



1ST FLOOR
298 sq.ft. (27.7 sq.m.) approx.



Piccadilly Close

Roselands

NN4 8RU

OFFERS OVER £190,000

This two bedroom semi-detached home is offered for sale in the very popular location of Roselands, part of NN4. The property provides good access to Upton Country Park, Sixfields Leisure Park as well as the town centre and train station.

The accommodation comprises entrance porch, sitting room with stairs to first floor and kitchen/dining room with door to garden. On the first floor are two double bedrooms and a family bathroom. Outside is a small lawned front garden with off road parking to the side for two to three vehicles. The rear garden has a patio area with the remainder laid to lawn with flower and shrub borders, side gated access and enclosed by timber fencing. Further benefits include uPVC double glazing and gas radiator heating. (C/617/M)

Additional information

- Council Tax Band: B
- Energy Efficiency Rating:

Viewing

Viewing strictly by appointment – details below

Disclaimer

O'Riordan Bond Estate Agents Limited has not tested apparatus, equipment, fittings or services and so cannot verify they are in working order. The buyer is advised to obtain verification from their solicitor or surveyor.

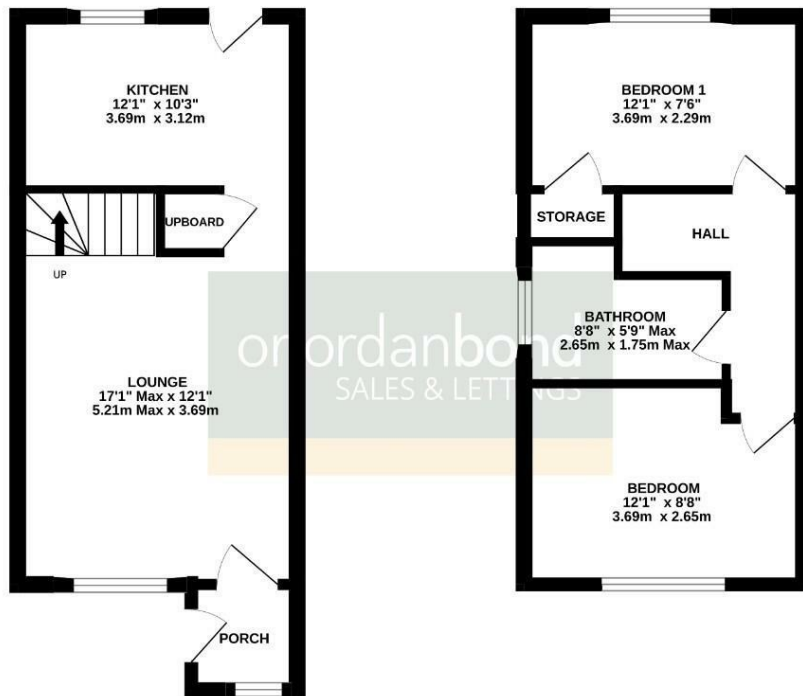

TOTAL FLOOR AREA: 617 sq.ft. (57.3 sq.m.) approx.

While every attempt has been made to ensure the accuracy of the floor plan contained here, measurements of doors, windows, rooms and any other items are approximate and no responsibility is taken for any error, omission or mis-statement. This plan is for illustrative purposes only and should be used as such by any prospective purchaser. The services, systems and appliances shown have not been tested and no guarantee as to their operability or efficiency can be given.
Made with Metreplan 6.0/2020

O'Riordan Bond Far Cotton Sales

01604 706007

farcotton@oriordanbond.co.uk

